

**FOOD TRUCK LOCATION 1****JACKSON COURT & O'BRIEN HALL FOOD TRUCK LOCATION:**

FOOD TRUCK LOCATION ON SIDEWALK CLOSEST TO THE LAWN ARE AT O'BRIEN HALL. THE VEHICLE WILL BE BACKED IN FACING TOWER ROAD FOR EASY ACCESS AND REMOVAL IF NEEDED. ACCESS FOR BOTH FIRE LANE TRAVEL AND PEDESTRIAN ACCESS WILL BE MAINTAINED AT ALL TIMES. THE FOOD TRUCK VENDOR WILL BE 25 FEET FROM THE BUILDING.

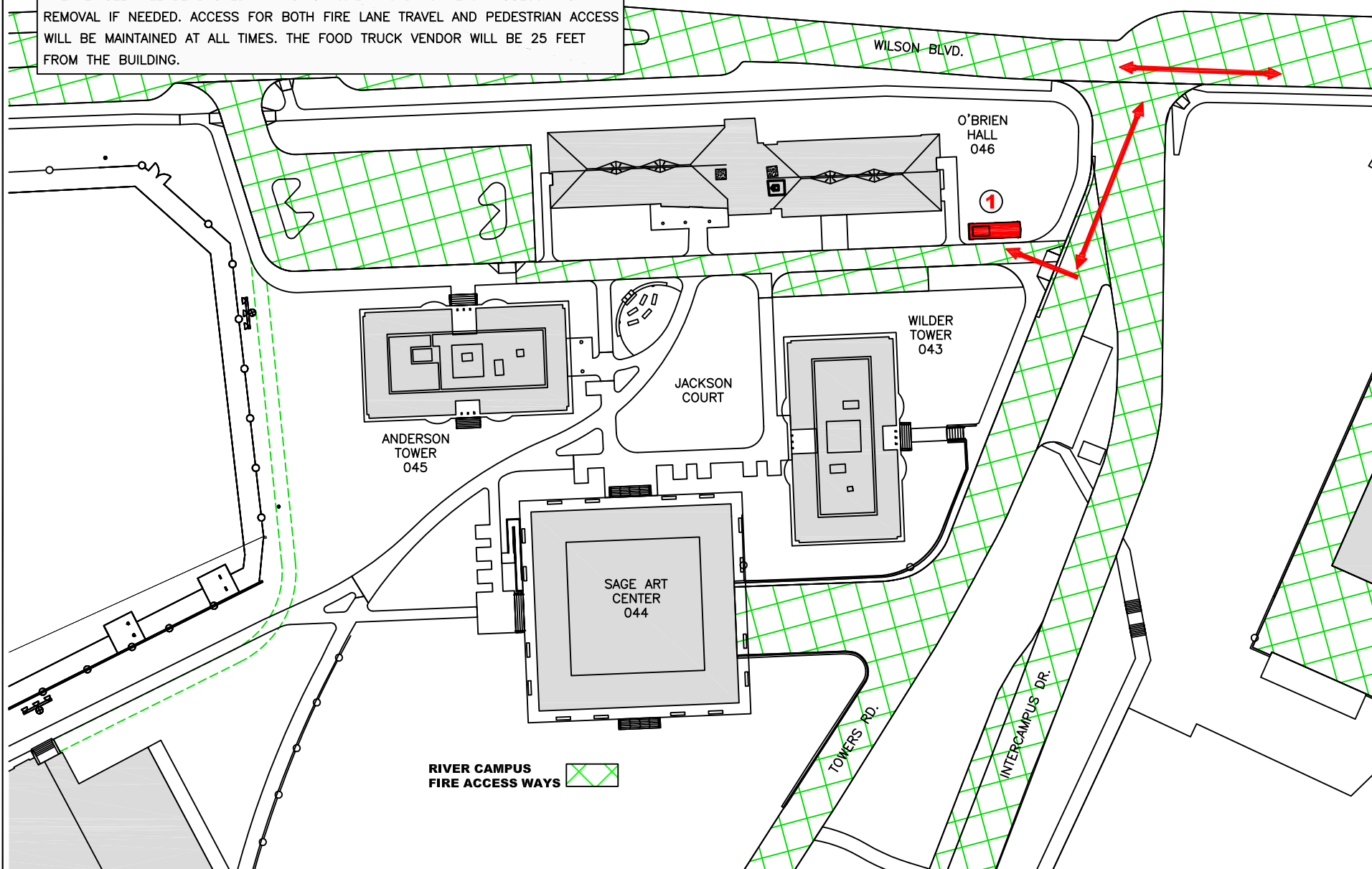

UNIVERSITY of  
**ROCHESTER**

DRAWN OR REVISED BY:  
KEVIN KEHOE

DATE DRAWN OR REVISED:  
04-15-16

DRAWING NAME:  
RC SITE PLAN  
FOOD TRUCK LOCATION

DRAWING SCALE:  
1" = 80'-0"

BUILDING NAME:  
AS NOTED

BUILDING NUMBER:  
AS NOTED

DRAWING LOCATION:  
H:\WORKING PLANS\SITE\AUTOCAD BASE SITE DRAWINGS\  
RC SITE PLAN\RC SITE PLAN FOOD TRUCK LOCATIONS

CAMPUS PLANNING, DESIGN & CONSTRUCTION MANAGEMENT